

PSR NEW GENERATION WASTEGATE QUICK GUIDE



CAUTION!

- WASTEGATES SHALL ONLY BE INSTALLED BY PROFESSIONAL AUTOMOTIVE MECHANICS WITH NECESSARY QUALIFICATION, KNOWLEDGE AND EQUIPMENT.
- MOUNT THE WASTEGATE WITH THE CAP AT LEAST **10CM OR 4"** AWAY FROM ANY ENGINE HEAT SOURCES TO PREVENT RAPID AGING OF THE DIAPHRAGM.
- **DO NOT** MOUNT THE WASTEGATE AT AN ANGLE LESS THAN 90 DEGREE TO THE EXHAUST FLOW TO PREVENT POOR BOOST CONTROL AND OVERBOOSTING.
- HIGH TEMP LOCTITE NEEDS TO BE APPLIED ON ALL FITTINGS TO PREVENT AIR OR COOLANT LEAKAGE FROM THE PORTS.

BILL OF MATERIAL

ITEM	ITEM NAME	QTY
1	Wastegate Main Body	1
2	Valve Seat	1
3	Spring Kit	1
4	Inlet V-Band Flange	1
5	Outlet V-Band Flange	1
6	Inlet Clamp	1
7	Outlet Clamp	1
8	PSR Wastegate Wrench	1
9	1/8" NPT NIPPLE	2
10	1/8" NPT PLUG	4

PIPE COMPATIBILITY

WG	INLET	OUTLET
45MM	1.875" OD	1.75" OD
50MM	2" OD	2" OD
60MM	2.5" OD	2.5" OD

SPRING IDENTIFIER CHART

WG Size	3PSI	5PSI	7PSI	14PSI	16PSI
38MM	Grey	Brown	Pink	Black	/
45/50MM	Red	Yellow	Green	Blue	/
60MM	Red	Yellow	Green	Blue	Purple

WG SIZE	1	1	2	3
38/45/50	3PSI	5PSI	7PSI	14PSI
3PSI	•			
5PSI		•		
7PSI			•	
10PSI	•		•	
12PSI		•	•	
14PSI				•
17PSI	•			•
19PSI		•		•
21PSI			•	•
24PSI	•		•	•
26PSI		•	•	•

14PSI SPRING
PRE-INSTALLED IN P3

16PSI SPRING
PRE-INSTALLED IN P4

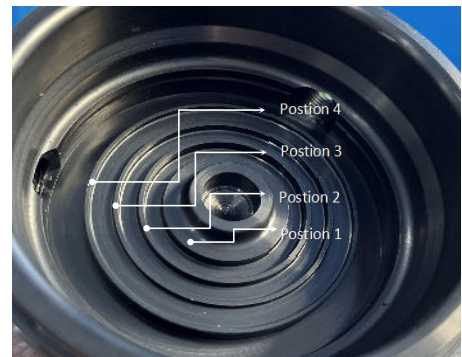

* Spring Pressure Accuracy: ± 0.5 PSI

WG SIZE	1	1	2	3	4
60	1PSI	3PSI	5PSI	10PSI	16PSI
3PSI		•			
5PSI			•		
6PSI	•		•		
8PSI		•	•		
10PSI				•	
11PSI	•			•	
13PSI		•		•	
15PSI			•	•	
16PSI					•
17PSI	•				•
18PSI		•	•	•	
19PSI		•			•
21PSI			•	•	•
22PSI	•		•	•	•
24PSI		•	•		•
26PSI				•	•
27PSI	•			•	•
29PSI		•		•	•
31PSI			•	•	•
32PSI	•		•	•	•
34PSI		•	•	•	•

* Spring Pressure Accuracy: ± 0.5 PSI



*CLEARANCE BETWEEN THE VALVE STEM AND BUSHING IS NECESSARY
AIR LEAKAGE WILL OCCUR WHEN ONLY APPLY BOOST TO THE WG CAP

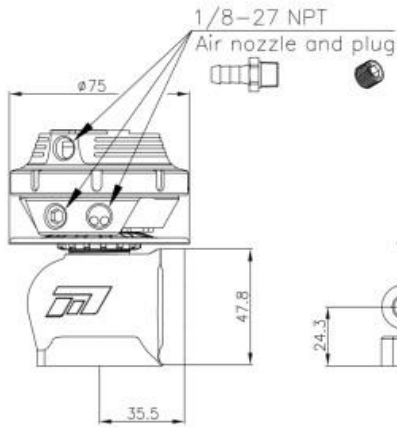

PSR NG 38MM WG

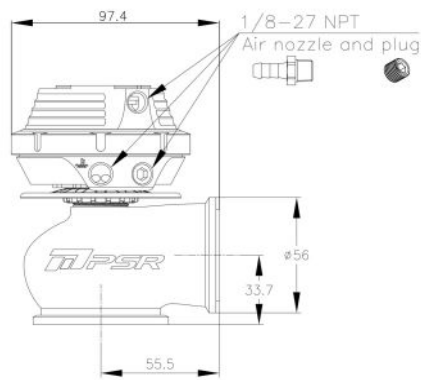
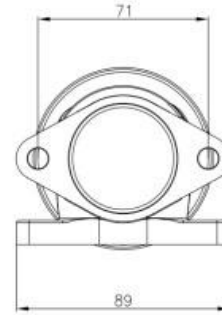

PSR NG 45MM WG

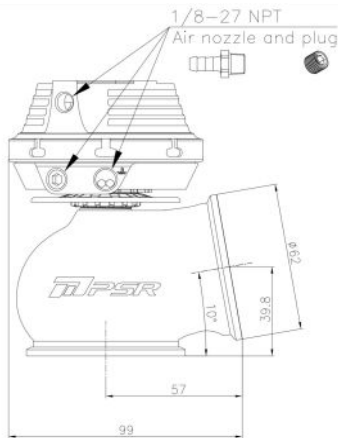

PSR NG 50MM WG

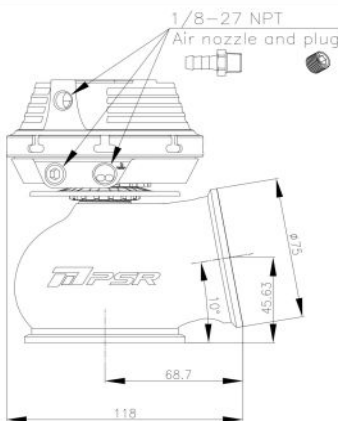
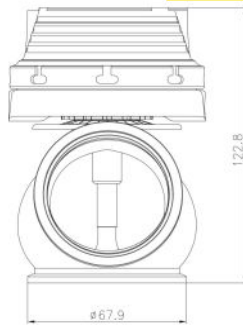

PSR NG 60MM WG

